

step 2

Follow these instructions to build and attach your LED Driver and Distributor

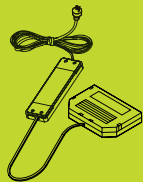

15W & 30W LED Driver (power supply) and distributor

installation guide

Things you need to know

- When using an electrical appliance, basic safety precautions should always be followed, including the following:
- Always read the instructions first before installation
- Not suitable for outdoor use
- Cut off the power source during the installation
- Don't bend the cables
- Keep proper ventilation around the unit and don't stack any objects on it.
- Keep 10-15 cm of clearance when the device is close to a heat source
- Check the information on the LED Driver label.
- **Please consider the total wattage of all lights being joined together and select the LED Driver that is greater than this total, taking into consideration the following:**
 - 15w = max load 13.5w
 - 30w = max load 27w
 - 75w = max load 67.5w
- If you have any questions, contact us on:
Australia: **1800 666 078** Monday to Friday between 8:00am and 6:00pm AEST, New Zealand: **0800 522 663** Monday to Friday between 8:00am and 5:00pm NZST or email: **info@kaboodlegroup.com.au**.
- **Caution:** Risk of electrical shock and energy hazard. If product fails to work, it should be examined by a qualified technician. Do not remove the case of the LED driver.
- Do not install LED Driver in places with high ambient temperature or close to fire source.
- Please refer to the specifications about the maximum ambient temperature limitations.
- Output current and output wattage must not exceed the rated values on the specifications
- If the LED Driver is damaged, the unit should be replaced.

Hardware included

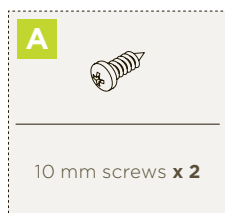

Tools you will need

To put your kaboodle LED driver together you will need the following tools.

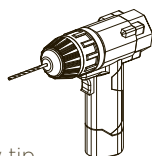

Cordless drill with:

- Number 2 screw tip
- 2mm drill bit

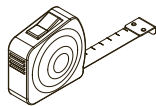

Tape measure



Pencil



Safety gear

LED driver (power supply) and distributor

connecting LED Driver without IR Control Switch

1. Connect the **Voltage LED Driver** and the **Distributor**
2. Connect the **LED Panel Cable(s)** into the **Distributor**
3. Connect **Driver** to power source.

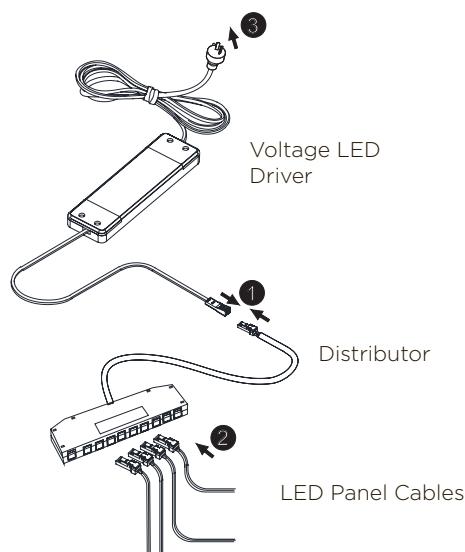

connecting LED Driver with IR Control Switch

1. Connect the **Voltage LED Driver** to the **IR Control Switch with cable**
2. Connect the **IR Control Switch with cable** to the **Distributor**
3. Connect the **Distributor** to the **LED Panel cable(s)**
4. Connect **Voltage LED Driver** into the power source

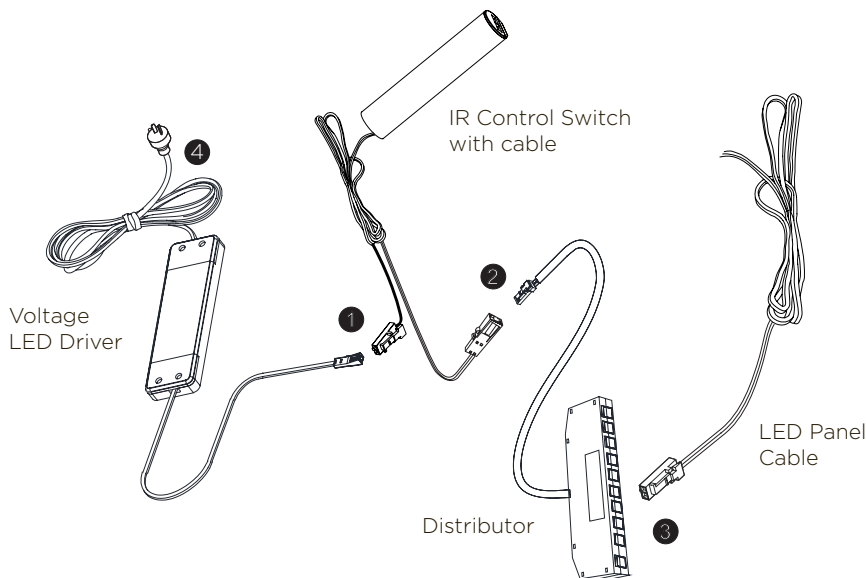

Caring for your kaboodle parts and accessories

Looking after your cabinets is really easy and with the right care and maintenance they will last you for many years. Just follow these simple steps and if you need any more information you can contact us on **1800 666 078** Monday to Friday between 8:00am and 6:00pm AEST or email: info@kaboodlegroup.com.au.

Hinges, runners and other parts and accessories should be kept dry at all times.

To keep the mechanisms performing at their best, regularly wipe them with a dry cloth removing any dust and grime that may build up.

We offer a dedicated customer service line for advice or any questions you may have on kaboodle products.

Call customer service on:
Australia: **1800 666 078** Monday to Friday between 8.00am and 6.00pm AEST

New Zealand: **0800 522 663** Monday to Friday between 8.00am and 5.00pm NZST or email: info@kaboodlegroup.com.au

step 1 ✓	Your Kaboodle cabinet is now complete.
step 4	Finish off your Kaboodle Kitchen by installing your benchtop.
step 2 ✓	You've finished adding your parts and accessories.
step 3	Next, follow the instructions to fit your doors and panels.